

GT_GM33/34

CO Transmitter Wall / Duct Type



Application

(Feature)

- Electrochemical Sensor with a long life, good long term stability and high accuracy.
- It has lower sensitivity to interferant gases.
- High repeatability.

(Application)

- Monitoring for HAVC / Air conditioning system
- Instrument testing equipment.
- Environmental control and monitoring system.
- Ventilation system control for indoor parking garages and building.

※ Application for environmental monitoring only. Not for CO industrial environmental and life support system.

Specification

Input

sensor type	Electrochemistry CO Sensor
measuring range	on request
working range	0 ... 500 PPM

Output

output	0~1V / 0~5V / 0~10V / 1~5V / 0~20mA / 4~20mA ; RS-485 ; RS-485 & analogue
signal connection	3-wire
linear accuracy (at 25 ± 2 °C, 40 ± 10 % RH)	± 3 % of F.S. (best zero-point)
sensitivity	< ± 10 ppm of measured value
load resistance	≤ 500Ω for 4~20mA ; ≥ 10 KΩ for 0~10V
output calibration	factory software calibration
response time (t90)	< 60 s

Environment

media measured	non-aggressive gas (HAVC system)
media temperature	0 ... 50 °C
working temperature	0 ... 50 °C
working humidity	5 ... 95 RH % (non-cond.)
storage temperature	-10 ... +60 °C
tolerance of zero-point	< ± 10 ppm

Electrical

power supply	12 ... 30 VAC / 8 ... 35 VDC
current consumption	DC24V:60mA;DC12V:180mA AC24V:140mA;AC12V:230mA
electrical connection	M12 (4P or 5P) metal connector with 2 m cable or terminal (cable gland)

Installation

installation	wall-mounting / duct-mounting flange
fixed	screw on base

Protection

protect degree	body : IP65 ; Sensor : IP20
electric protection	☉Polarity protection ☉over-voltage ☉short-circuit

Certification

certification	CE
---------------	----

Material

case	PC fire-proof class (PC-110) (UL94V-2)
weight	GM33 : 162g GM34 : 205g

Ordering Guide

ordering code -----	GT_GM 33 - 1 1 1 1 - 0 M
Installation	33
Input	1
Output	1
Power supply	1
CO range	1
Modbus	0
Option	M

【Ordering item】

Installation	code	Input	code	Output	code	Power supply	code	CO range	code
wall	33	CO	1	4~20 mA	1	12~30 VAC or 8~35 VDC	1	100 PPM	1
duct	34			0~20 mA	2			300 PPM	3
				1~5 V	5			500 PPM	5
				0~10 V	6			RS-485	N
				0~5 V	7				
				0~1 V	8				
				RS-485	N				

Modbus	code	Option	code
analogue	0	cable gland	N
RS-485	1	M12 (4P or 5P)	M
RS-485 & analogue	2	metal connector (with 2 m cable)	
※ M type - M12 (5P) metal connector or N type - M16 cable gland			

Electric Connector

【 M type (M12-4PIN metal connector) 】
RS-485 or analogue

【 M type (M12-5PIN metal connector) 】
RS-485+analogue

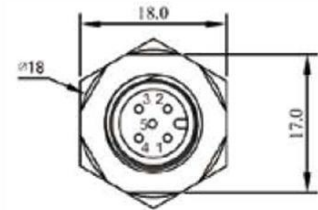
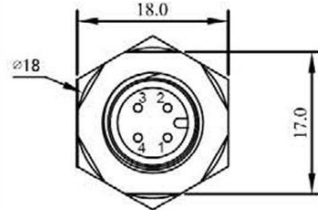
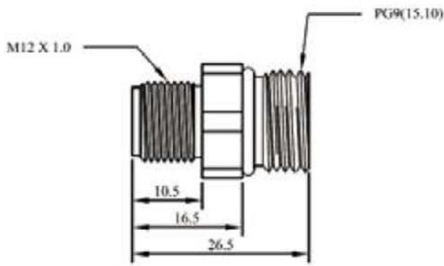

【 N type (M12 cable gland) 】 RS-485 or analogue

【 N type (M16 cable gland) 】 RS-485+analogue

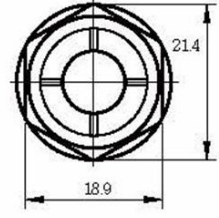
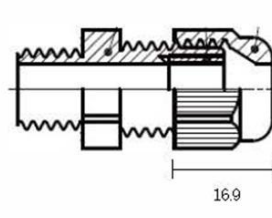
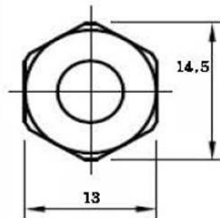
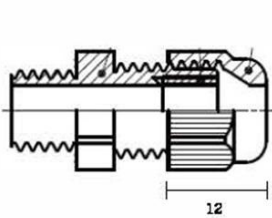

unit : mm

Dimension

[GT_GM33(indoor)]

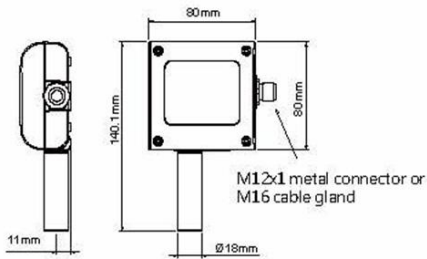

M type (4P) : RS-485 or analogue
M type (5P) or N type : RS-485 + analogue

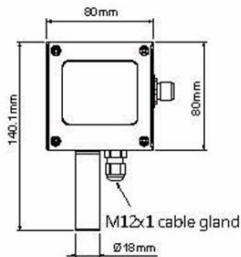

N type : RS-485 or analogue

[GT_GM34(duct)]

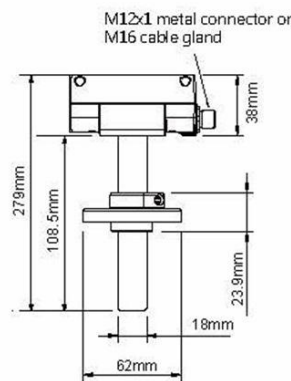

M type (4P) : RS-485 or analogue
M type (5P) or N type : RS-485+analogue

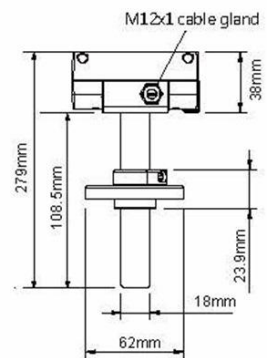

N type : RS-485 or analogue

Analogue Diagram

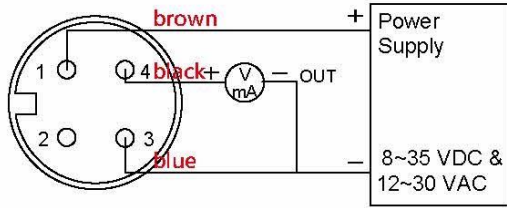

M12 connector

M type (4P)

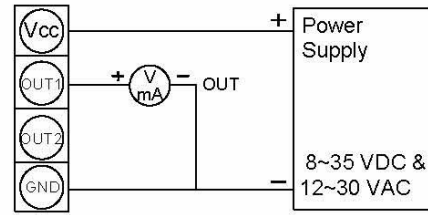

4P terminal

N型

RS-485 Diagram

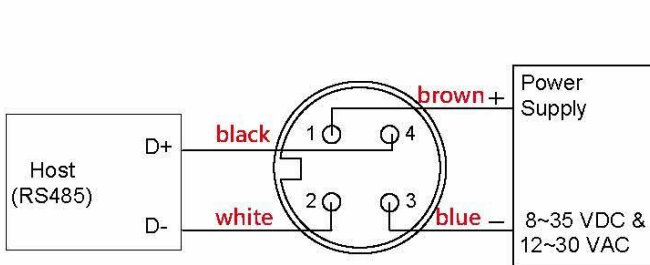

M type (4P)

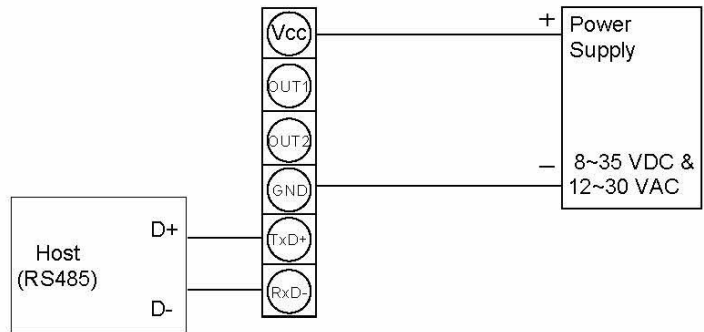

N type

Analogue + RS-485 Diagram

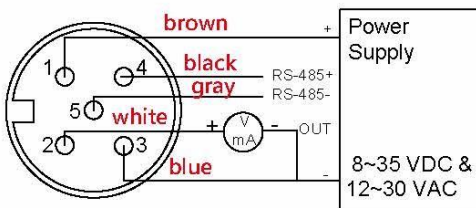

M type (M12, 5P) connector

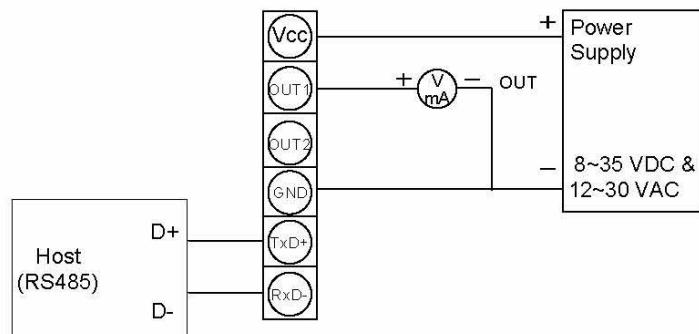

N type (M16)